



### MONOCOVE-XS

MONOCOVE-XS is a highly efficient, modular, connectable and seamless miniature linear LED lighting system. The integrated connector system enables the XS to be quickly and easily installed within architectural lighting details such as coves, slots and coffers.

Manufactured from extruded anodised aluminium, with silver finish, as standard. Custom powder coated options (white / black / RAL) are also available. The 11mm shallow profile, combined with clear cover and industry leading Nichia LEDs, provides a highly efficient miniature luminaire.

A wide range of LED options are available, with a choice of Nichia, Osram and Lumiled LED. Colour temperatures range from 2000K ~ 4000K with power output options ranging from 4.8w/m ~ 24w/m. Each PCB module has an on-board Integrated Controller (IC), for precise constant current control, whilst a Schottky diode provides reverse polarity protection.

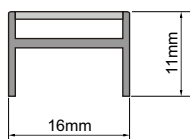

### FINISH



### TECHNICAL

|                                    |                                     |
|------------------------------------|-------------------------------------|
| <b>Input voltage:</b>              | 24VDC [22.5~25VDC]                  |
| <b>Current control:</b>            | On-board integrated controller (IC) |
| <b>Reverse voltage protection:</b> | On-board Schottky diode             |
| <b>Operating temperature (Ta):</b> | -35 °C ~ 40 °C                      |
| <b>Dimmable:</b>                   | PWM (Pulse-Width Modulation)        |
| <b>Ingress protection:</b>         | IP40                                |



## SPECIFICATION

| XS                                | B      | CC       | N112 | /9  | N4-827K  | Lumens per metre  |  |  |  |  | 2000   |
|-----------------------------------|--------|----------|------|---|--|---|--|--|--|--|--|
| Profile                           | Colour | Diffuser | PCB  | Wattage   | Spectrum   | /4  | /9   | /14  | /19  | /24  | Length   |
| A Aluminium<br>W White<br>B Black |        | CC Clear | N112 | /4 4.8w/m<br>/9 9.6w/m<br>/14 14.4w/m<br>/19 19.2w/m<br>/24 24.0w/m | <b>N4-820K</b> 2000K ≥Ra80 455<br><b>N4-920K</b> 2000K ≥Ra90 381<br><b>N4-822K</b> 2200K ≥Ra80 493<br><b>N4-922K</b> 2200K ≥Ra90 412<br><b>N4-825K</b> 2500K ≥Ra80 539<br><b>N4-925K</b> 2500K ≥Ra90 447<br><b>N4-827K</b> 2700K ≥Ra80 630<br><b>N4-927K</b> 2700K ≥Ra90 544<br><b>N4-027K</b> 2700K ≥Ra95 463<br><b>N4-830K</b> 3000K ≥Ra80 649<br><b>N4-930K</b> 3000K ≥Ra90 560<br><b>N4-030K</b> 3000K ≥Ra95 473<br><b>N4-835K</b> 3500K ≥Ra80 664<br><b>N4-935K</b> 3500K ≥Ra90 573<br><b>N4-035K</b> 3500K ≥Ra95 483<br><b>N4-840K</b> 4000K ≥Ra80 666<br><b>N4-940K</b> 4000K ≥Ra90 579<br><b>N4-040K</b> 4000K ≥Ra95 489<br><b>N4-850K</b> 5000K ≥Ra80 711<br><b>N4-950K</b> 5000K ≥Ra90 612<br><b>N4-050K</b> 5000K ≥Ra95 524<br><b>N4-857K</b> 5700K ≥Ra80 686<br><b>N4-957K</b> 5700K ≥Ra90 608<br><b>N4-865K</b> 6500K ≥Ra80 686<br><b>N4-965K</b> 6500K ≥Ra90 605 | 455<br>381<br>493<br>412<br>539<br>447<br>630<br>544<br>463<br>649<br>560<br>473<br>664<br>573<br>483<br>666<br>579<br>489<br>711<br>612<br>524<br>686<br>608<br>686<br>605 | 907<br>734<br>981<br>795<br>1074<br>862<br>1257<br>1055<br>860<br>1294<br>1085<br>878<br>1324<br>1111<br>898<br>1327<br>1122<br>908<br>1381<br>1191<br>981<br>1332<br>1183<br>1332<br>1176 | 1313<br>1053<br>1420<br>1140<br>1555<br>1236<br>1819<br>1516<br>1216<br>1873<br>1558<br>1243<br>1916<br>1595<br>1270<br>1921<br>1612<br>1286<br>1996<br>1711<br>1394<br>1925<br>1700<br>1925<br>2211 | 1720<br>1377<br>1860<br>1490<br>2036<br>1617<br>2381<br>1982<br>1585<br>2453<br>2038<br>1619<br>2509<br>2087<br>1654<br>2516<br>2108<br>1676<br>2629<br>2239<br>1822<br>2537<br>2225<br>2537<br>2687 | 2093<br>1670<br>2264<br>1807<br>2479<br>1960<br>2900<br>2407<br>1925<br>2985<br>2475<br>1967<br>3054<br>2535<br>2009<br>3062<br>2561<br>2035<br>3206<br>2721<br>2217<br>3093<br>2703<br>3093<br>2687 | <b>125</b> 125mm<br><b>250</b> 250mm<br><b>500</b> 500mm<br><b>1000</b> 1000mm<br><b>1500</b> 1500mm<br><b>2000</b> 2000mm<br><b>2500</b> 2500mm<br><b>3000</b> 3000mm |

Other colour temperatures, tuneable white, RGB and RGBW available upon request.

## MODULE TYPE

### STAND-ALONE

Luminaire - L  
Endcaps at both ends

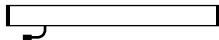

### CONTINUOUS LINE

Start module - S  
Endcap at the start

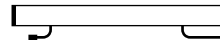

Middle module - M  
No endcaps

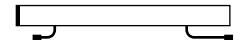

End module - E  
Endcap at the end

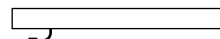

Full module - F  
Endcaps at both ends

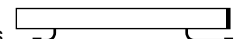

## ACCESSORIES

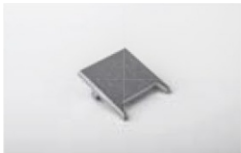

XS-EC End cap



XS-SMB Mounting bracket



XS-MAG Magnetic bracket



XS-AMB Adjustable bracket

### Disclaimer:

Technical data is subject to change without prior notice. The data provide represent typical values. Due to tolerances in the production of components and binning of LEDs, values for lumen output (Lm), colour temperature (CCT) and power (W/m) can vary up to 10%. Electrical and thermal variation also influences the performance characteristics of LEDs