

MONOCOVE-XXM

MONOCOVE-XXM is a efficient, modular, connectable and seamless miniature linear LED lighting system. The integrated connector system enables the XXM to be quickly and easily installed within architectural lighting details such as coves, slots and coffers.

Manufactured from extruded anodised aluminium, with silver finish, as standard. Custom powder coated options (white / black / RAL) are also available. The 21mm shallow profile, combined with opal cover and industry leading Nichia LEDs, provides a miniature and connectable luminaire with uniform 'dot-free' diffuser.

A wide range of LED options are available, with a choice of Nichia, Osram and Lumiled LED. Colour temperatures range from 2000K ~ 6500K with power output options ranging from 4.8w/m ~ 24w/m. Each PCB module has an on-board Integrated Controller (IC), for precise constant current control, whilst a Schottky diode provides reverse polarity protection.

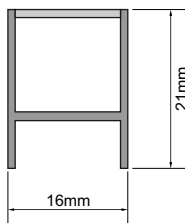

FINISH



TECHNICAL

Input voltage:	24VDC [22.5~25VDC]
Current control:	On-board integrated controller (IC)
Reverse voltage protection:	On-board Schottky diode
Operating temperature (Ta):	-35 °C ~ 40 °C
Dimmable:	PWM (Pulse-Width Modulation)
Ingress protection:	IP67



SPECIFICATION

Profile	Colour	Diffuser	PCB	Wattage	Spectrum	Lumens per metre					Length	
						/4	/9	/14	/19	/24		
XMx B	OC N112	OC Opal N112	N112	/4	4.8w/m	N4-820K 2000K ≥Ra80 N4-920K 2000K ≥Ra90 N4-822K 2200K ≥Ra80 N4-922K 2200K ≥Ra90 N4-825K 2500K ≥Ra80 N4-925K 2500K ≥Ra90 N4-827K 2700K ≥Ra80 N4-927K 2700K ≥Ra90 N4-027K 2700K ≥Ra95 N4-830K 3000K ≥Ra80 N4-930K 3000K ≥Ra90 N4-030K 3000K ≥Ra95 N4-835K 3500K ≥Ra80 N4-935K 3500K ≥Ra90 N4-035K 3500K ≥Ra95 N4-840K 4000K ≥Ra80 N4-940K 4000K ≥Ra90 N4-040K 4000K ≥Ra95 N4-850K 5000K ≥Ra80 N4-950K 5000K ≥Ra90 N4-050K 5000K ≥Ra95 N4-857K 5700K ≥Ra80 N4-957K 5700K ≥Ra90 N4-865K 6500K ≥Ra80 N4-965K 6500K ≥Ra90	228	461	684	918	1132	125 125mm 250 250mm 500 500mm 1000 1000mm 1500 1500mm 2000 2000mm 2500 2500mm 3000 3000mm
				/9	9.6w/m		198	386	561	743	911	
				/14	14.4w/m		247	499	740	993	1224	
				/19	19.2w/m		214	418	607	804	973	
				/24	24.0w/m	271	546	810	1087	1340		

Other colour temperatures, tuneable white, RGB and RGBW available upon request.

MODULE TYPE

STAND-ALONE

Luminaire - L
Endcaps at both ends

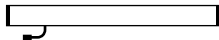

CONTINUOUS LINE

Start module - S
Endcap at the start

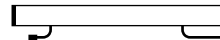

Middle module - M
No endcaps

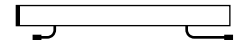

End module - E
Endcap at the end

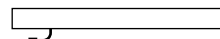

Full module - F
Endcaps at both ends

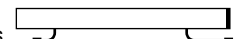

ACCESSORIES

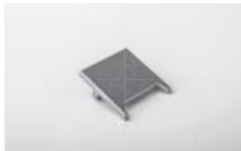

XMx-EC End cap



XMx-SMB Mounting bracket



XMx-MAG Magnetic bracket



XMx-AMB Adjustable bracket

Disclaimer:

Technical data is subject to change without prior notice. The data provide represent typical values. Due to tolerances in the production of components and binning of LEDs, values for lumen output (Lm), colour temperature (CCT) and power (W/m) can vary up to 10%. Electrical and thermal variation also influences the performance characteristics of LEDs