



### MONOCOVE-XM

MONOCOVE-XM is an efficient, modular, connectable and seamless miniature linear LED lighting system. The integrated connector system enables the XM to be quickly and easily installed within architectural lighting details such as coves, slots and coffers.

Manufactured from extruded anodised aluminium, with silver finish, as standard. Custom powder coated options (white / black / RAL) are also available. The 21mm shallow profile, combined with opal cover and industry leading Nichia LEDs, provides a miniature and connectable luminaire with uniform 'dot-free' diffuser.

A wide range of LED options are available, with a choice of Nichia, Osram and Lumiled LED. Colour temperatures range from 2000K ~ 6500K with power output options ranging from 4.8w/m ~ 24w/m. Each PCB module has an on-board Integrated Controller (IC), for precise constant current control, whilst a Schottky diode provides reverse polarity protection.

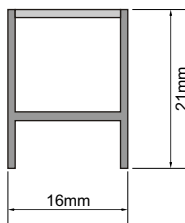

### FINISH



### TECHNICAL

|                                    |                                     |
|------------------------------------|-------------------------------------|
| <b>Input voltage:</b>              | 24VDC [22.5~25VDC]                  |
| <b>Current control:</b>            | On-board integrated controller (IC) |
| <b>Reverse voltage protection:</b> | On-board Schottky diode             |
| <b>Operating temperature (Ta):</b> | -35 °C ~ 40 °C                      |
| <b>Dimmable:</b>                   | PWM (Pulse-Width Modulation)        |
| <b>Ingress protection:</b>         | IP40                                |



## SPECIFICATION

| XM  | B      | OC       | N112 | /9      | N4-827K  | Lumens per metre |             |     |     |      | 2000   |      |      |        |
|---|--------|----------|------|---------|----------|------------------|-------------|-----|-----|------|--------|------|------|--------|
| Profile   | Colour | Diffuser | PCB  | Wattage | Spectrum | /4               | /9          | /14 | /19 | /24  | Length |      |      |        |
| <ul style="list-style-type: none"> <li>A Aluminium</li> <li>W White</li> <li>B Black</li> </ul> |        | OC Opal  | N112 | /4      | 4.8w/m   | N4-820K          | 2000K ≥Ra80 | 243 | 491 | 728  | 977    | 1204 | 125  | 125mm  |
|   |        |          |      | /9      | 9.6w/m   | N4-920K          | 2000K ≥Ra90 | 210 | 411 | 597  | 791    | 970  | 250  | 250mm  |
|   |        |          |      | /14     | 14.4w/m  | N4-822K          | 2200K ≥Ra80 | 263 | 531 | 788  | 1057   | 1303 | 500  | 500mm  |
|   |        |          |      | /19     | 19.2w/m  | N4-922K          | 2200K ≥Ra90 | 228 | 444 | 646  | 856    | 1036 | 1000 | 1000mm |
|   |        |          |      | /24     | 24.0w/m  | N4-825K          | 2500K ≥Ra80 | 288 | 581 | 862  | 1157   | 1427 | 1500 | 1500mm |
|   |        |          |      |         |          | N4-925K          | 2500K ≥Ra90 | 247 | 482 | 701  | 928    | 1138 | 2000 | 2000mm |
|   |        |          |      |         |          | N4-827K          | 2700K ≥Ra80 | 337 | 680 | 1008 | 1353   | 1668 | 2500 | 2500mm |
|   |        |          |      |         |          | N4-927K          | 2700K ≥Ra90 | 299 | 587 | 855  | 1136   | 1393 | 3000 | 3000mm |
|   |        |          |      |         |          | N4-027K          | 2700K ≥Ra95 | 268 | 499 | 708  | 924    | 1164 |      |        |
|   |        |          |      |         |          | N4-830K          | 3000K ≥Ra80 | 347 | 700 | 1038 | 1393   | 1718 |      |        |
|   |        |          |      |         |          | N4-930K          | 3000K ≥Ra90 | 307 | 603 | 880  | 1168   | 1433 |      |        |
|   |        |          |      |         |          | N4-030K          | 3000K ≥Ra95 | 274 | 510 | 724  | 945    | 1189 |      |        |
|   |        |          |      |         |          | N4-835K          | 3500K ≥Ra80 | 355 | 716 | 1062 | 1425   | 1758 |      |        |
|   |        |          |      |         |          | N4-935K          | 3500K ≥Ra90 | 314 | 618 | 901  | 1196   | 1467 |      |        |
|   |        |          |      |         |          | N4-035K          | 3500K ≥Ra95 | 279 | 520 | 740  | 965    | 1214 |      |        |
|   |        |          |      |         |          | N4-840K          | 4000K ≥Ra80 | 356 | 718 | 1065 | 1429   | 1763 |      |        |
|   |        |          |      |         |          | N4-940K          | 4000K ≥Ra90 | 317 | 624 | 910  | 1208   | 1482 |      |        |
|   |        |          |      |         |          | N4-040K          | 4000K ≥Ra95 | 283 | 527 | 749  | 977    | 1230 |      |        |
|   |        |          |      |         |          | N4-850K          | 5000K ≥Ra80 | 392 | 767 | 1118 | 1486   | 1826 |      |        |
|   |        |          |      |         |          | N4-950K          | 5000K ≥Ra90 | 335 | 660 | 964  | 1281   | 1570 |      |        |
|   |        |          |      |         |          | N4-050K          | 5000K ≥Ra95 | 301 | 565 | 806  | 1056   | 1332 |      |        |
|   |        |          |      |         |          | N4-857K          | 5700K ≥Ra80 | 378 | 740 | 1079 | 1433   | 1762 |      |        |
|   |        |          |      |         |          | N4-957K          | 5700K ≥Ra90 | 333 | 656 | 958  | 1272   | 1560 |      |        |
|   |        |          |      |         |          | N4-865K          | 6500K ≥Ra80 | 378 | 740 | 1079 | 1433   | 1762 |      |        |
|   |        |          |      |         |          | N4-965K          | 6500K ≥Ra90 | 331 | 652 | 952  | 1264   | 1550 |      |        |

Other colour temperatures, tuneable white, RGB and RGBW available upon request.

## MODULE TYPE

### STAND-ALONE

Luminaire - L  
Endcaps at both ends

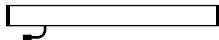

### CONTINUOUS LINE

Start module - S  
Endcap at the start

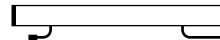

Middle module - M  
No endcaps

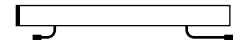

End module - E  
Endcap at the end

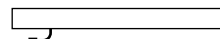

Full module - F  
Endcaps at both ends

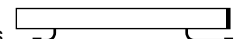

## ACCESSORIES

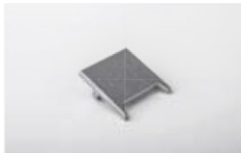

XM-EC End cap



XM-SMB Mounting bracket



XM-MAG Magnetic bracket



XM-AMB Adjustable bracket

### Disclaimer:

Technical data is subject to change without prior notice. The data provide represent typical values. Due to tolerances in the production of components and binning of LEDs, values for lumen output (Lm), colour temperature (CCT) and power (W/m) can vary up to 10%. Electrical and thermal variation also influences the performance characteristics of LEDs